

MIL-38999 Receptacle – FC/ST/SC/LC Cable Sets for In-Box Applications

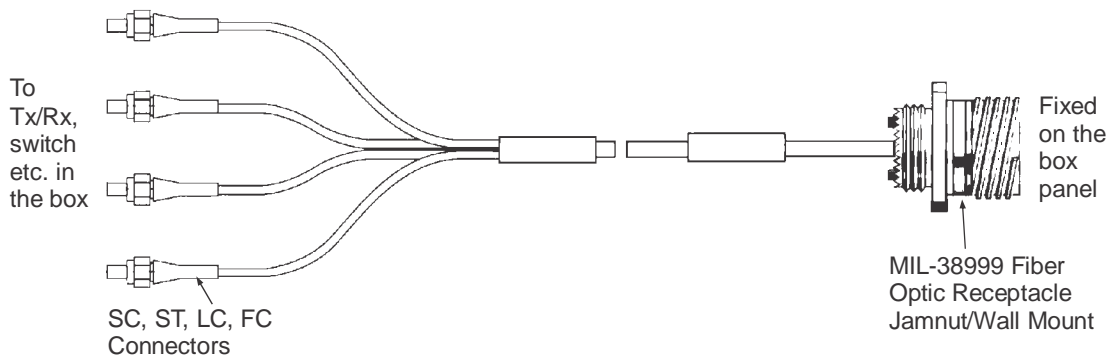

These MIL-38999 Receptacle to SC/ST/LC/FC Cable Sets are designed for MILitary applications 'inside-box'. The SC/ST/LC/FC side mates to the transceiver (or other equipment) inside the box. The MIL-38999 receptacle side is mounted on the box and is eventually mated with outside environment plug. We provide custom cable lengths, number of fibres, connectors as per choice like SC, ST, LC, FC, MT-RJ etc.

FEATURES

- Number of Fiber Channels as per choice – 1, 2, 4, 8, 12 etc
- Various combinations of MT-RJ, ST, FC, SC, LC to MIL-38999 Receptacle
- Custom cable type & lengths possible
- Singlemode 9/125um, Multimode 50/125um & 62.5/125um can be chosen
- MIL-DTL-38999 Receptacles can be Jamnut type or Wall Mount type

APPLICATIONS

- Enclosures in Radars, MILitary Systems, Ground Control Systems, Launchers etc
- Applications where equipment inside enclosure needs to be connected to outside environment
- **MIL-38999 Qualified Glenair/Amphenol** or equivalent connectors
- Imported OFNR/OFNP Grade FO cable
- Imported Hi-End FC/ST/SC/LC connectors

How to Specify Part Numbers for Cable Sets:

STF - $\square\square\square\square\square / \square\square\square\square\square - \square F / \square\square M / \square\square\square\square \square\square\square\square - 00$
A A A B C A A A B C N X X Y Y Y Y Z Z K K K

A	2 digit connector Code	09 = ST SM; 11 = ST MM 50/125; 13 = ST MM 62.5/125; 15 = SC SM; 17 = SC MM 50/125; 19 = SC MM 62.5/125; 21 = LC SM; 23 = ST LC 50/125; 25 = LC MM 62.5/125; 27 = FC SM; 29 = FC MM 50/125; 31 = FC MM 62.5/125; 9/125 Jamnut Recep: 60 = 2 ch; 63 = 4 ch ; 66 = 8 ch 50&62.5/125 Jamnut Receptacle: 69 = 2 ch; 70 = 4 ch ; 73 = 8 ch
B	Connector Type	Straight = S ; Right Angle= R ; Jamnut Receptacle = J ; Wall Mount Receptacle = W
C	Connector Style	Male/Plug = P ; Female = J
D	Termini Style	Male/Plug = P ; Female/Socket = J ; Omit if no termini
N	No. of Fibers in cable	1 = 1 fiber ; 2 = 2 fiber; 4 = 4 fiber ; 8 = 8 fiber
XX	2 digit code for mode	9S = 9/125um singlemode ; 5M = 50/125um multimode; 6M = 62.5/125um multimode ; CM = 50/125 & 62.5/125 multimode
YYY	Length (meter/Km)	100 meter = 100M ; 1 Km = 1KM ; 1 feet = 1F
ZZ	2 digit cable code	DI = Distribution Style ; BR = Breakout; RI = Riser
KKK	Cable class code	Breakout = 023; Distribution = 065; Riser = 120

1m assembly SM 9/125um, ST St.Plug both sides, 1 Fiber = STF-09SPP/09SPP-1F/9SM/1M-RI120-00

Shown trademarks are property of their respective owners.

While the information contained herein in this catalog, has been carefully compiled to the best of our knowledge, nothing is intended as representation and warranty on our part; and no statement shall be construed as recommendation to infringe any of existing patents. We accept no liability of whatsoever for any faults and errors in the information contained herein. Contents of this catalogue and specifications of the products, are subject to change without notice due to continuous improvements.

Connectors for MIL38999 Receptacle – SC/ST/LC/FC Cable Sets

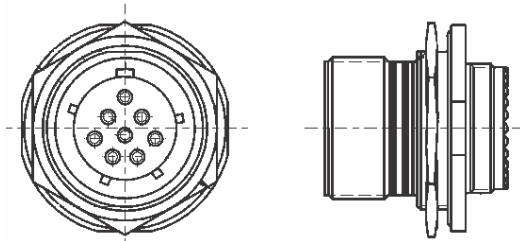

MIL-38999 Fiber Optic Jam Nut Receptacle

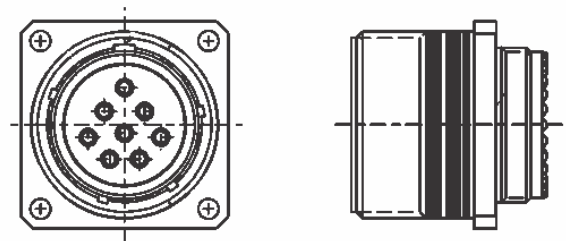

MIL-38999 Fiber Optic Wall Mount Receptacle

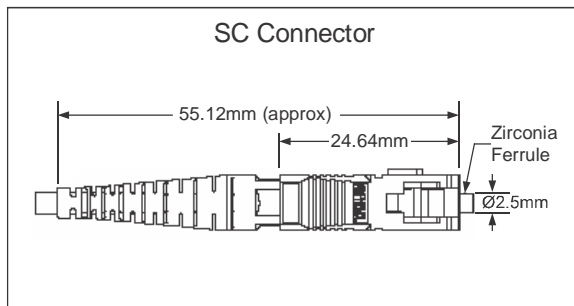

SC Connector

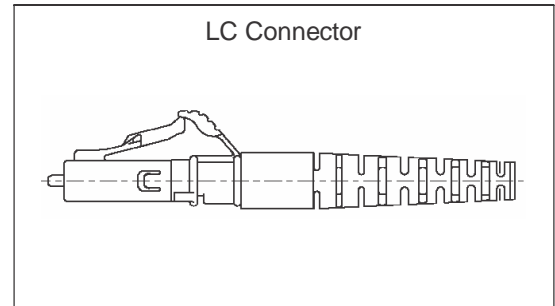

LC Connector

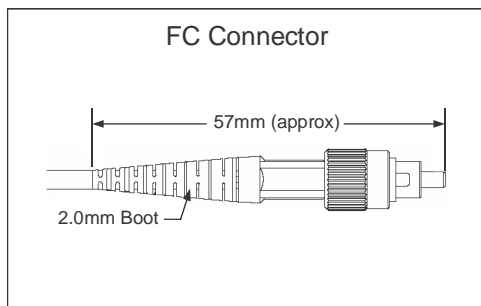

FC Connector

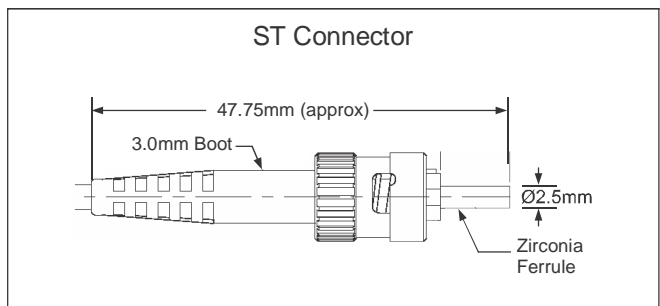

ST Connector

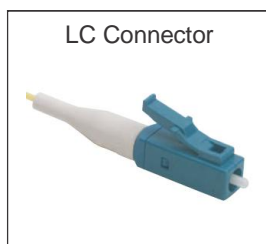

LC Connector



SC Connector



FC Connector



ST Connector

Shown trademarks are property of their respective owners.

While the information contained herein in this catalog, has been carefully compiled to the best of our knowledge, nothing is intended as representation and warranty on our part; and no statement shall be construed as recommendation to infringe any of existing patents. We accept no liability of whatsoever for any faults and errors in the information contained herein. Contents of this catalogue and specifications of the products, are subject to change without notice due to continuous improvements.

MIL-38999 Jamnut Receptacle – ST Fiber Optic Cable Sets

P/N for Fiber Optic Assembly	Mode	Size	No. of Fibers	Conn. 1	Conn. 2 (38999) type size		Len. meter
STF-09SP/60JJK-2F/9SM/1M-RI120-00	Single	9/125	2	2xST(M)	Jamnut	11	1
STF-09SP/63JJK-4F/9SM/1M- RI120-00	Single	9/125	4	4xST(M)	Jamnut	13	1
STF-09SP/66JJK-8F/9SM/1M- RI120-00	Single	9/125	8	8xST(M)	Jamnut	17	1
STF-09SP/60JJK-2F/9SM/2M-RI120-00	Single	9/125	2	2xST(M)	Jamnut	11	2
STF-09SP/63JJK-4F/9SM/2M- RI120-00	Single	9/125	4	4xST(M)	Jamnut	13	2
STF-09SP/66JJK-8F/9SM/2M- RI120-00	Single	9/125	8	8xST(M)	Jamnut	17	2
STF-09SP/60JJK-2F/9SM/3M-RI120-00	Single	9/125	2	2xST(M)	Jamnut	11	3
STF-09SP/63JJK-4F/9SM/3M- RI120-00	Single	9/125	4	4xST(M)	Jamnut	13	3
STF-09SP/66JJK-8F/9SM/3M- RI120-00	Single	9/125	8	8xST(M)	Jamnut	17	3
STF-09SP/60JJK-2F/9SM/5M-RI120-00	Single	9/125	2	2xST(M)	Jamnut	11	5
STF-09SP/63JJK-4F/9SM/5M- RI120-00	Single	9/125	4	4xST(M)	Jamnut	13	5
STF-09SP/66JJK-8F/9SM/5M- RI120-00	Single	9/125	8	8xST(M)	Jamnut	17	5
STF-11SP/69JJK-2F/5MM/1M-RI120-00	Multi	50/125	2	2xST(M)	Jamnut	11	1
STF-11SP/70JJK-4F/5MM/1M-RI120-00	Multi	50/125	4	4xST(M)	Jamnut	13	1
STF-11SP/73JJK-8F/5MM/1M-RI120-00	Multi	50/125	8	8xST(M)	Jamnut	17	1
STF-11SP/69JJK-2F/5MM/2M-RI120-00	Multi	50/125	2	2xST(M)	Jamnut	11	2
STF-11SP/70JJK-4F/5MM/2M-RI120-00	Multi	50/125	4	4xST(M)	Jamnut	13	2
STF-11SP/73JJK-8F/5MM/2M-RI120-00	Multi	50/125	8	8xST(M)	Jamnut	17	2
STF-11SP/69JJK-2F/5MM/3M-RI120-00	Multi	50/125	2	2xST(M)	Jamnut	11	3
STF-11SP/70JJK-4F/5MM/3M-RI120-00	Multi	50/125	4	4xST(M)	Jamnut	13	3
STF-11SP/73JJK-8F/5MM/3M-RI120-00	Multi	50/125	8	8xST(M)	Jamnut	17	3
STF-11SP/69JJK-2F/5MM/5M-RI120-00	Multi	50/125	2	2xST(M)	Jamnut	11	5
STF-11SP/70JJK-4F/5MM/5M-RI120-00	Multi	50/125	4	4xST(M)	Jamnut	13	5
STF-11SP/73JJK-8F/5MM/5M-RI120-00	Multi	50/125	8	8xST(M)	Jamnut	17	5
STF-13SP/69JJK-2F/6MM/1M-RI120-00	Multi	62.5/125	2	2xST(M)	Jamnut	11	1
STF-13SP/70JJK-4F/6MM/1M-RI120-00	Multi	62.5/125	4	4xST(M)	Jamnut	13	1
STF-13SP/73JJK-8F/6MM/1M-RI120-00	Multi	62.5/125	8	8xST(M)	Jamnut	17	1
STF-13SP/69JJK-2F/6MM/2M-RI120-00	Multi	62.5/125	2	2xST(M)	Jamnut	11	2
STF-13SP/70JJK-4F/6MM/2M-RI120-00	Multi	62.5/125	4	4xST(M)	Jamnut	13	2
STF-13SP/73JJK-8F/6MM/2M-RI120-00	Multi	62.5/125	8	8xST(M)	Jamnut	17	2
STF-13SP/69JJK-2F/6MM/3M-RI120-00	Multi	62.5/125	2	2xST(M)	Jamnut	11	3
STF-13SP/70JJK-4F/6MM/3M-RI120-00	Multi	62.5/125	4	4xST(M)	Jamnut	13	3
STF-13SP/73JJK-8F/6MM/3M-RI120-00	Multi	62.5/125	8	8xST(M)	Jamnut	17	3
STF-13SP/69JJK-2F/6MM/5M-RI120-00	Multi	62.5/125	2	2xST(M)	Jamnut	11	5
STF-13SP/70JJK-4F/6MM/5M-RI120-00	Multi	62.5/125	4	4xST(M)	Jamnut	13	5
STF-13SP/73JJK-8F/6MM/5M-RI120-00	Multi	62.5/125	8	8xST(M)	Jamnut	17	5

Shown trademarks are property of their respective owners.

While the information contained herein in this catalog, has been carefully compiled to the best of our knowledge, nothing is intended as representation and warranty on our part; and no statement shall be construed as recommendation to infringe any of existing patents. We accept no liability of whatsoever for any faults and errors in the information contained herein. Contents of this catalogue and specifications of the products, are subject to change without notice due to continuous improvements.

MIL-38999 Jamnut Receptacle – SC Fiber Optic Cable Sets

P/N for Fiber Optic Assembly	Mode	Size	No. of Fibers	Conn. 1	Conn. 2 (38999)		Len. meter
					type	size	
STF-15SP/60JJJ-2F/9SM/1M-RI120-00	Single	9/125	2	2xSC(M)	Jamnut	11	1
STF-15SP/63JJJ-4F/9SM/1M- RI120-00	Single	9/125	4	4xSC(M)	Jamnut	13	1
STF-15SP/66JJJ-8F/9SM/1M- RI120-00	Single	9/125	8	8xSC(M)	Jamnut	17	1
STF-15SP/60JJJ-2F/9SM/2M-RI120-00	Single	9/125	2	2xSC(M)	Jamnut	11	2
STF-15SP/63JJJ-4F/9SM/2M- RI120-00	Single	9/125	4	4xSC(M)	Jamnut	13	2
STF-15SP/66JJJ-8F/9SM/2M- RI120-00	Single	9/125	8	8xSC(M)	Jamnut	17	2
STF-15SP/60JJJ-2F/9SM/3M-RI120-00	Single	9/125	2	2xSC(M)	Jamnut	11	3
STF-15SP/63JJJ-4F/9SM/3M- RI120-00	Single	9/125	4	4xSC(M)	Jamnut	13	3
STF-15SP/66JJJ-8F/9SM/3M- RI120-00	Single	9/125	8	8xSC(M)	Jamnut	17	3
STF-15SP/60JJJ-2F/9SM/5M-RI120-00	Single	9/125	2	2xSC(M)	Jamnut	11	5
STF-15SP/63JJJ-4F/9SM/5M- RI120-00	Single	9/125	4	4xSC(M)	Jamnut	13	5
STF-15SP/66JJJ-8F/9SM/5M- RI120-00	Single	9/125	8	8xSC(M)	Jamnut	17	5
STF-17SP/69JJJ-2F/5MM/1M-RI120-00	Multi	50/125	2	2xSC(M)	Jamnut	11	1
STF-17SP/70JJJ-4F/5MM/1M-RI120-00	Multi	50/125	4	4xSC(M)	Jamnut	13	1
STF-17SP/73JJJ-8F/5MM/1M-RI120-00	Multi	50/125	8	8xSC(M)	Jamnut	17	1
STF-17SP/69JJJ-2F/5MM/2M-RI120-00	Multi	50/125	2	2xSC(M)	Jamnut	11	2
STF-17SP/70JJJ-4F/5MM/2M-RI120-00	Multi	50/125	4	4xSC(M)	Jamnut	13	2
STF-17SP/73JJJ-8F/5MM/2M-RI120-00	Multi	50/125	8	8xSC(M)	Jamnut	17	2
STF-17SP/69JJJ-2F/5MM/3M-RI120-00	Multi	50/125	2	2xSC(M)	Jamnut	11	3
STF-17SP/70JJJ-4F/5MM/3M-RI120-00	Multi	50/125	4	4xSC(M)	Jamnut	13	3
STF-17SP/73JJJ-8F/5MM/3M-RI120-00	Multi	50/125	8	8xSC(M)	Jamnut	17	3
STF-17SP/69JJJ-2F/5MM/5M-RI120-00	Multi	50/125	2	2xSC(M)	Jamnut	11	5
STF-17SP/70JJJ-4F/5MM/5M-RI120-00	Multi	50/125	4	4xSC(M)	Jamnut	13	5
STF-17SP/73JJJ-8F/5MM/5M-RI120-00	Multi	50/125	8	8xSC(M)	Jamnut	17	5
STF-19SP/69JJJ-2F/6MM/1M-RI120-00	Multi	62.5/125	2	2xSC(M)	Jamnut	11	1
STF-19SP/70JJJ-4F/6MM/1M-RI120-00	Multi	62.5/125	4	4xSC(M)	Jamnut	13	1
STF-19SP/73JJJ-8F/6MM/1M-RI120-00	Multi	62.5/125	8	8xSC(M)	Jamnut	17	1
STF-19SP/69JJJ-2F/6MM/2M-RI120-00	Multi	62.5/125	2	2xSC(M)	Jamnut	11	2
STF-19SP/70JJJ-4F/6MM/2M-RI120-00	Multi	62.5/125	4	4xSC(M)	Jamnut	13	2
STF-19SP/73JJJ-8F/6MM/2M-RI120-00	Multi	62.5/125	8	8xSC(M)	Jamnut	17	2
STF-19SP/69JJJ-2F/6MM/3M-RI120-00	Multi	62.5/125	2	2xSC(M)	Jamnut	11	3
STF-19SP/70JJJ-4F/6MM/3M-RI120-00	Multi	62.5/125	4	4xSC(M)	Jamnut	13	3
STF-19SP/73JJJ-8F/6MM/3M-RI120-00	Multi	62.5/125	8	8xSC(M)	Jamnut	17	3
STF-19SP/69JJJ-2F/6MM/5M-RI120-00	Multi	62.5/125	2	2xSC(M)	Jamnut	11	5
STF-19SP/70JJJ-4F/6MM/5M-RI120-00	Multi	62.5/125	4	4xSC(M)	Jamnut	13	5
STF-19SP/73JJJ-8F/6MM/5M-RI120-00	Multi	62.5/125	8	8xSC(M)	Jamnut	17	5

Shown trademarks are property of their respective owners.

While the information contained herein in this catalog, has been carefully compiled to the best of our knowledge, nothing is intended as representation and warranty on our part; and no statement shall be construed as recommendation to infringe any of existing patents. We accept no liability of whatsoever for any faults and errors in the information contained herein. Contents of this catalogue and specifications of the products, are subject to change without notice due to continuous improvements.

MIL-38999 Receptacle – FC/ST/SC/LC Cable Sets for In-Box Applications

MIL-38999 Jamnut Receptacle – LC Fiber Optic Cable Sets

P/N for Fiber Optic Assembly	Mode	Size	No. of Fibers	Conn. 1	Conn. 2 (38999)		Len. meter
					type size		
STF-21SP/60JJJ-2F/9SM/1M-RI120-00	Single	9/125	2	2xLC(M)	Jamnut	11	1
STF-21SP/63JJJ-4F/9SM/1M- RI120-00	Single	9/125	4	4xLC(M)	Jamnut	13	1
STF-21SP/66JJJ-8F/9SM/1M- RI120-00	Single	9/125	8	8xLC(M)	Jamnut	17	1
STF-21SP/60JJJ-2F/9SM/2M-RI120-00	Single	9/125	2	2xLC(M)	Jamnut	11	2
STF-21SP/63JJJ-4F/9SM/2M- RI120-00	Single	9/125	4	4xLC(M)	Jamnut	13	2
STF-21SP/66JJJ-8F/9SM/2M- RI120-00	Single	9/125	8	8xLC(M)	Jamnut	17	2
STF-21SP/60JJJ-2F/9SM/3M-RI120-00	Single	9/125	2	2xLC(M)	Jamnut	11	3
STF-21SP/63JJJ-4F/9SM/3M- RI120-00	Single	9/125	4	4xLC(M)	Jamnut	13	3
STF-21SP/66JJJ-8F/9SM/3M- RI120-00	Single	9/125	8	8xLC(M)	Jamnut	17	3
STF-21SP/60JJJ-2F/9SM/5M-RI120-00	Single	9/125	2	2xLC(M)	Jamnut	11	5
STF-21SP/63JJJ-4F/9SM/5M- RI120-00	Single	9/125	4	4xLC(M)	Jamnut	13	5
STF-21SP/66JJJ-8F/9SM/5M- RI120-00	Single	9/125	8	8xLC(M)	Jamnut	17	5
STF-23SP/69JJJ-2F/5MM/1M-RI120-00	Multi	50/125	2	2xLC(M)	Jamnut	11	1
STF-23SP/70JJJ-4F/5MM/1M-RI120-00	Multi	50/125	4	4xLC(M)	Jamnut	13	1
STF-23SP/73JJJ-8F/5MM/1M-RI120-00	Multi	50/125	8	8xLC(M)	Jamnut	17	1
STF-23SP/69JJJ-2F/5MM/2M-RI120-00	Multi	50/125	2	2xLC(M)	Jamnut	11	2
STF-23SP/70JJJ-4F/5MM/2M-RI120-00	Multi	50/125	4	4xLC(M)	Jamnut	13	2
STF-23SP/73JJJ-8F/5MM/2M-RI120-00	Multi	50/125	8	8xLC(M)	Jamnut	17	2
STF-23SP/69JJJ-2F/5MM/3M-RI120-00	Multi	50/125	2	2xLC(M)	Jamnut	11	3
STF-23SP/70JJJ-4F/5MM/3M-RI120-00	Multi	50/125	4	4xLC(M)	Jamnut	13	3
STF-23SP/73JJJ-8F/5MM/3M-RI120-00	Multi	50/125	8	8xLC(M)	Jamnut	17	3
STF-23SP/69JJJ-2F/5MM/5M-RI120-00	Multi	50/125	2	2xLC(M)	Jamnut	11	5
STF-23SP/70JJJ-4F/5MM/5M-RI120-00	Multi	50/125	4	4xLC(M)	Jamnut	13	5
STF-23SP/73JJJ-8F/5MM/5M-RI120-00	Multi	50/125	8	8xLC(M)	Jamnut	17	5
STF-25SP/69JJJ-2F/6MM/1M-RI120-00	Multi	62.5/125	2	2xLC(M)	Jamnut	11	1
STF-25SP/70JJJ-4F/6MM/1M-RI120-00	Multi	62.5/125	4	4xLC(M)	Jamnut	13	1
STF-25SP/73JJJ-8F/6MM/1M-RI120-00	Multi	62.5/125	8	8xLC(M)	Jamnut	17	1
STF-25SP/69JJJ-2F/6MM/2M-RI120-00	Multi	62.5/125	2	2xLC(M)	Jamnut	11	2
STF-25SP/70JJJ-4F/6MM/2M-RI120-00	Multi	62.5/125	4	4xLC(M)	Jamnut	13	2
STF-25SP/73JJJ-8F/6MM/2M-RI120-00	Multi	62.5/125	8	8xLC(M)	Jamnut	17	2
STF-25SP/69JJJ-2F/6MM/3M-RI120-00	Multi	62.5/125	2	2xLC(M)	Jamnut	11	3
STF-25SP/70JJJ-4F/6MM/3M-RI120-00	Multi	62.5/125	4	4xLC(M)	Jamnut	13	3
STF-25SP/73JJJ-8F/6MM/3M-RI120-00	Multi	62.5/125	8	8xLC(M)	Jamnut	17	3
STF-25SP/69JJJ-2F/6MM/5M-RI120-00	Multi	62.5/125	2	2xLC(M)	Jamnut	11	5
STF-25SP/70JJJ-4F/6MM/5M-RI120-00	Multi	62.5/125	4	4xLC(M)	Jamnut	13	5
STF-25SP/73JJJ-8F/6MM/5M-RI120-00	Multi	62.5/125	8	8xLC(M)	Jamnut	17	5

Shown trademarks are property of their respective owners.

While the information contained herein in this catalog, has been carefully compiled to the best of our knowledge, nothing is intended as representation and warranty on our part; and no statement shall be construed as recommendation to infringe any of existing patents. We accept no liability of whatsoever for any faults and errors in the information contained herein. Contents of this catalogue and specifications of the products, are subject to change without notice due to continuous improvements.